

**DERBYSHIRE COUNTY COUNCIL**

**TEMPORARY FOOTPATH CLOSURE**

**PUBLIC FOOTPATH NO.93 NEW MILLS**

**WHEN: 26<sup>th</sup> July 2019 to 25<sup>th</sup> January 2020**

**WHERE: Close Public Footpath NO.93 from its junction with Grove Street to its junction with Public Footpath NO.94**

**REASON: To facilitate public safety due to damage to the footbridge.**

**ALTERNATIVE ROUTE: No alternative route is recommended**

Access will be maintained, whenever reasonably possible, on the affected length of footpath. The footpath will re-open as soon as the work is finished. This may be earlier than advertised.

Derbyshire County Council apologises for any inconvenience caused while work takes place. Anyone needing further information should ring Call Derbyshire 01629 533190.

The County Council intends to make an Order under Section 14 of the Road Traffic Regulation Act 1984 (as amended) to prohibit its use by traffic.

**Mike Ashworth, Executive Director – Economy, Transport and Environment, County Hall, MATLOCK DE4 3AG**

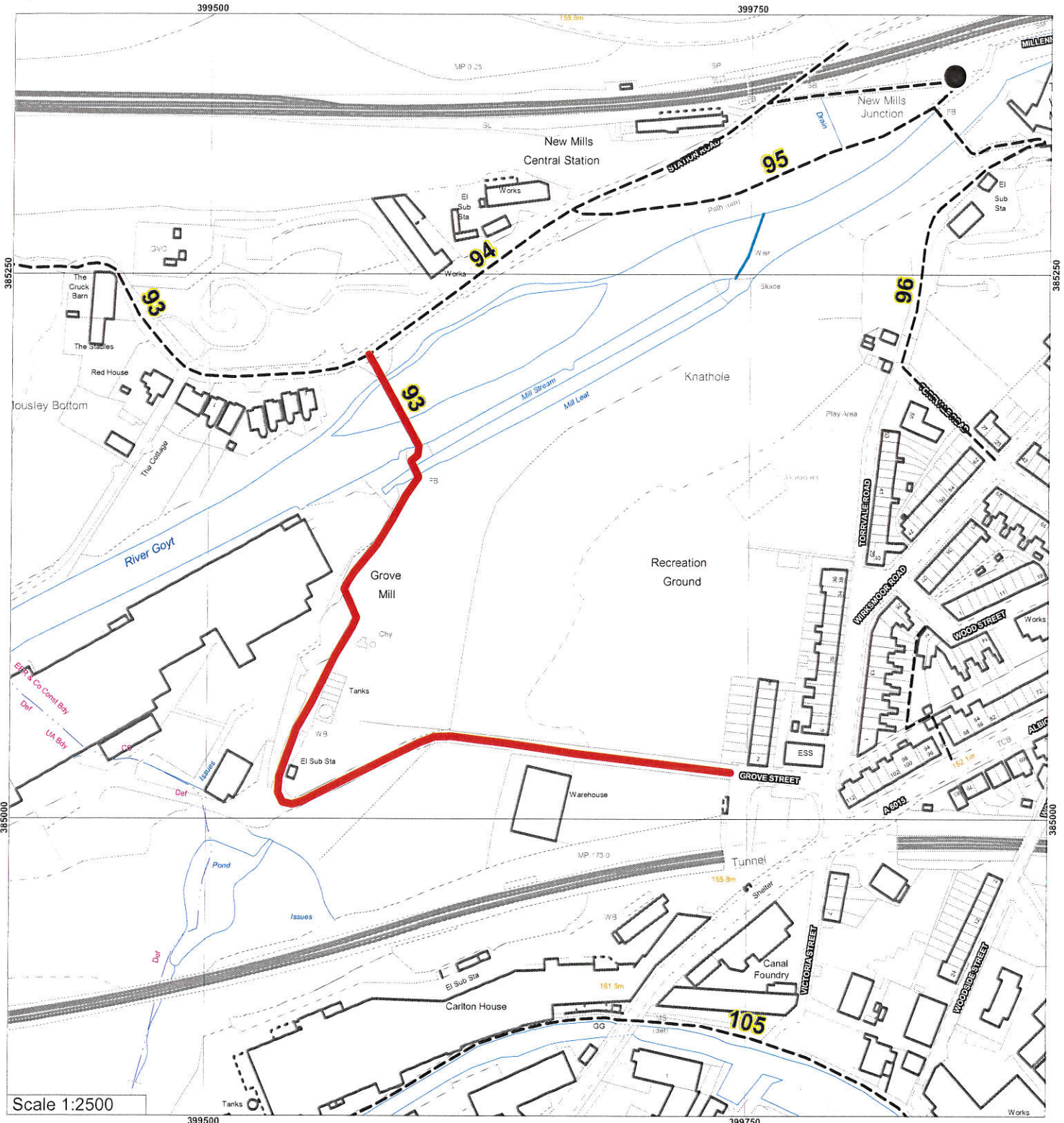

Scale 1:2500

Road Traffic Regulation Act 1984 s14  
**TEMPORARY CLOSURE**  
 NEW MILLS FOOTPATH 93

- PATH CLOSED**
- UNAFFECTED FOOTPATH**
- PARISH BOUNDARY**



**Mike Ashworth**  
 Executive Director  
 Economy, Transport & Environment  
 Derbyshire County Council  
 Shand House  
 Dale Road South  
 Matlock  
 DE4 3RY

Produced by Public Rights of Way  
 Ref:  
 © Crown copyright and database rights [2018].  
 Ordnance Survey [100023251].  
 You are not permitted to copy, sub-licence, distribute or sell any of this data to third parties in any form.